



fuze

Yealink T48 Series

Fuze for Yealink

Contact Directory

This module is best viewed as 'fit to page' via Google Chrome or Microsoft Edge.

Click Start to begin.

Start

Contact Directory

Contacts, Speed Dial, Buddy Watch

This module will cover the contact directory and setting up line key functionality.

Use the 'Next' button and clickable hotspots to navigate through this interactive guide.

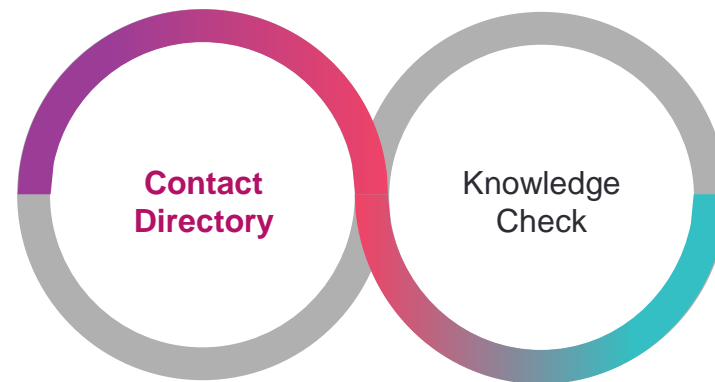

Accessing the Contact Directory

The Contact Directory may be synced to include company contacts as well as a local directory on the phone.

To access the Contact Directory:

- Tap the **Directory**  shortcut key

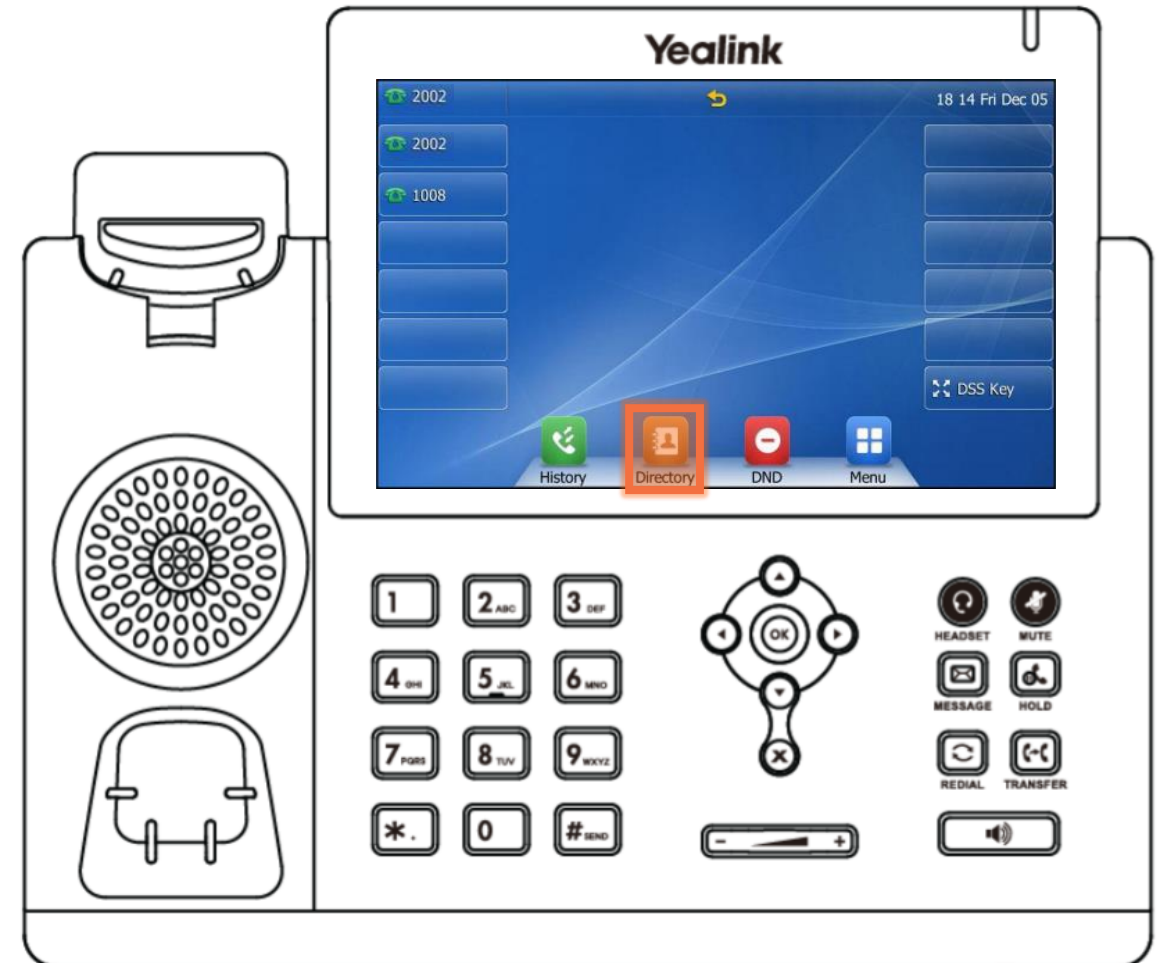

Accessing the Contact Directory

Tap to highlight the appropriate directory.

If no other directories have been added, the **All Contacts** directory will be highlighted.

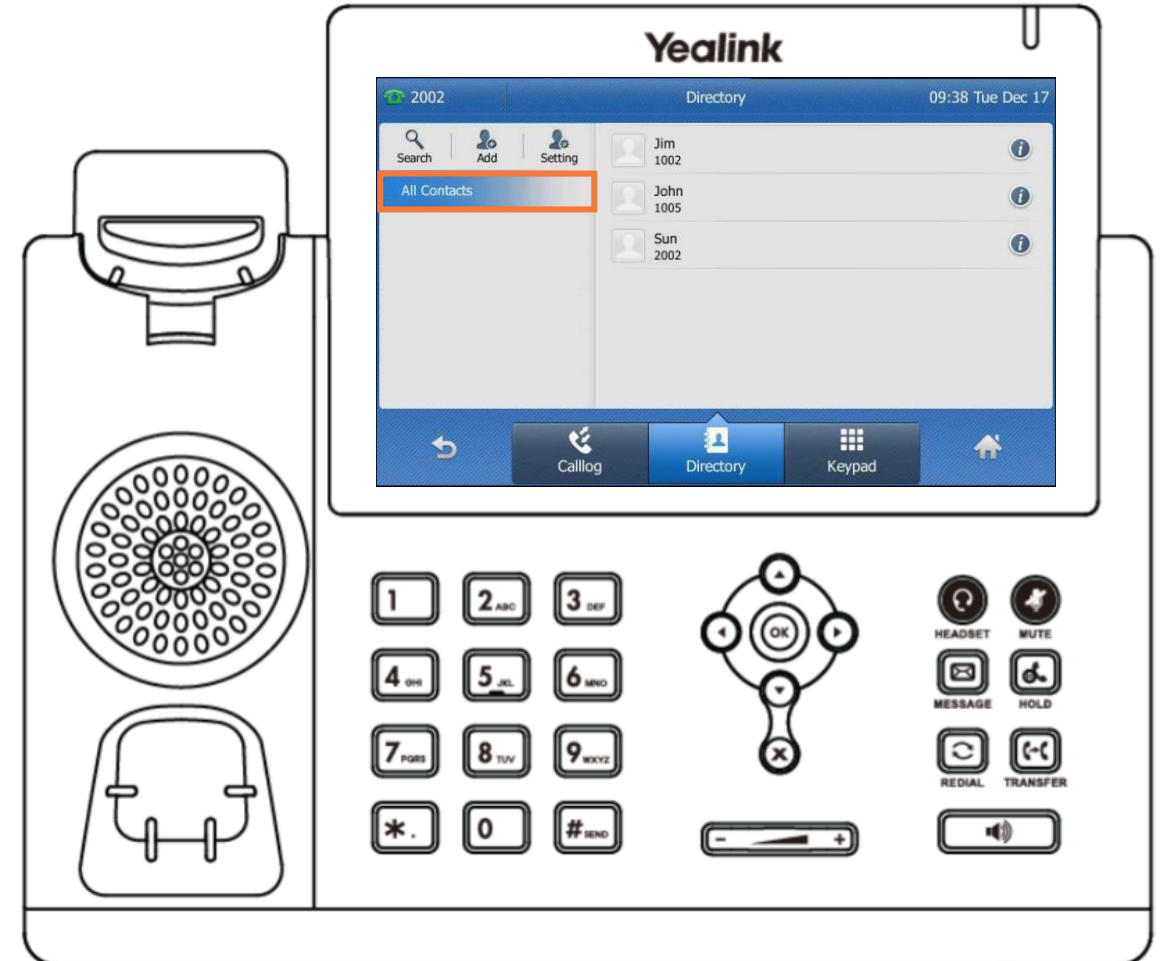

Searching the Contact Directory

To search for a contact within the directory:

- Tap **Search** 

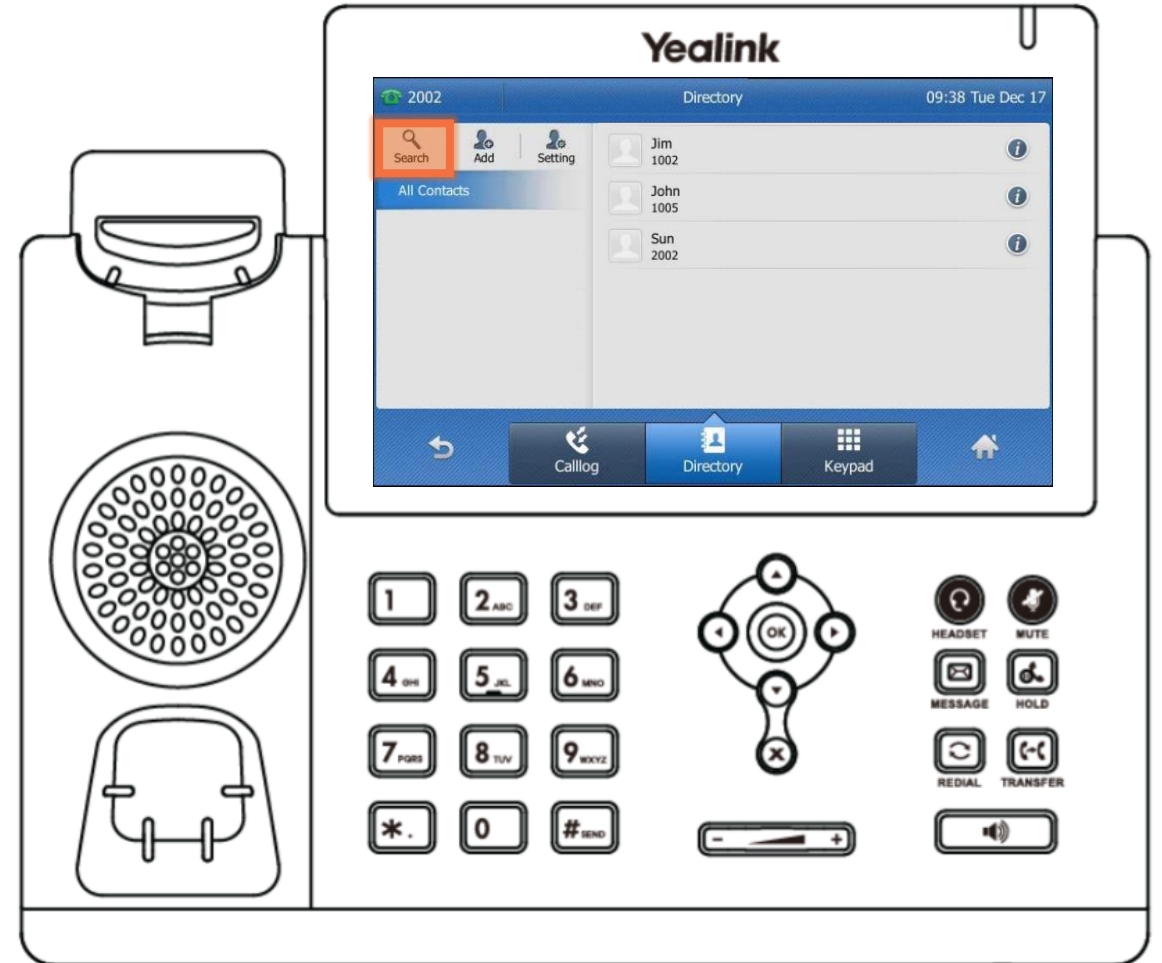

Searching the Contact Directory

- Use the dial pad to enter search criteria for the contact
 - It is possible to search by first or last name, or by the contact's extension
- Once the search results display, tap the  icon next to the contact

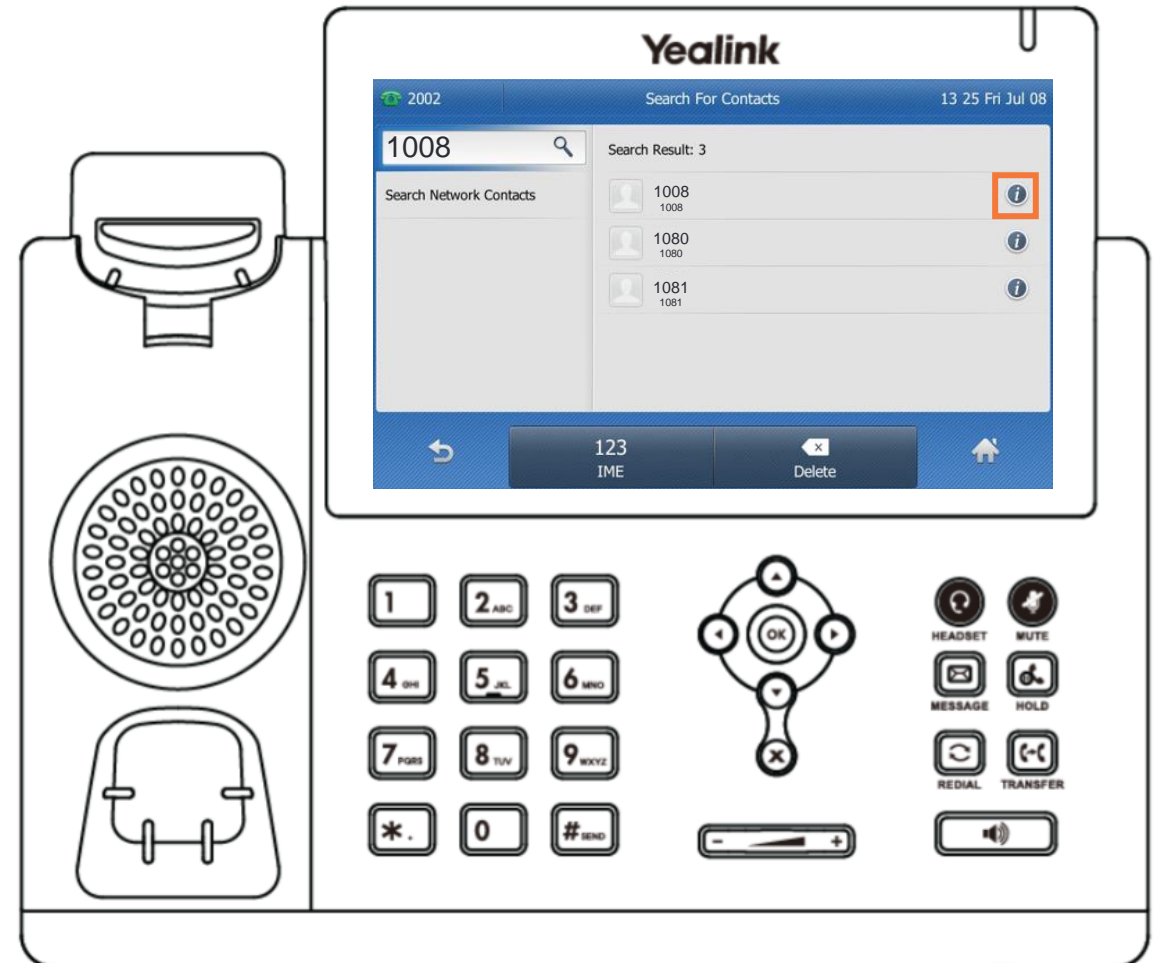

Calling a Contact

With the contact selected:

- Tap **Send** 

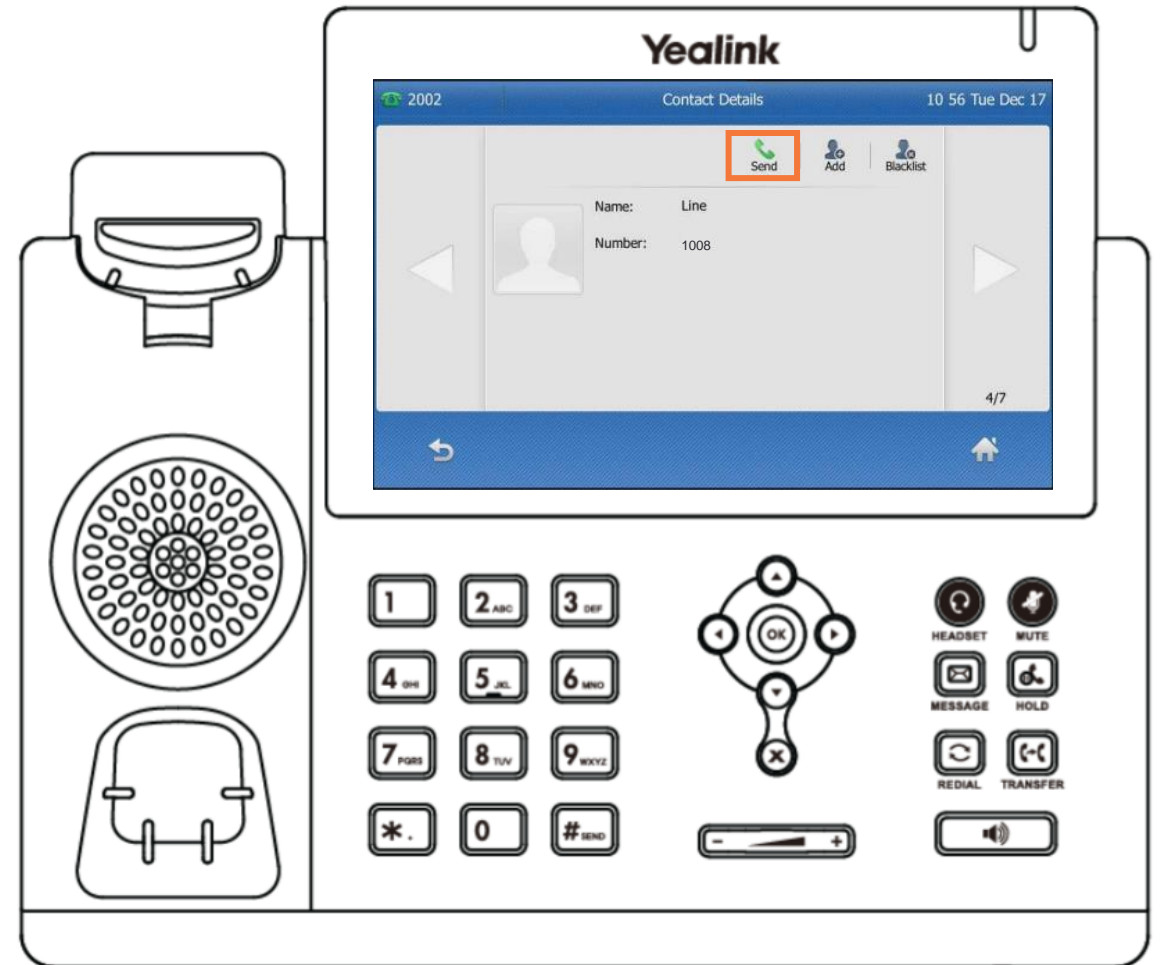

Adding a Contact

Daniel is a regular customer but is not currently included in the phone's directory.

Once inside the directory, to add a contact:

- Tap **Add** 

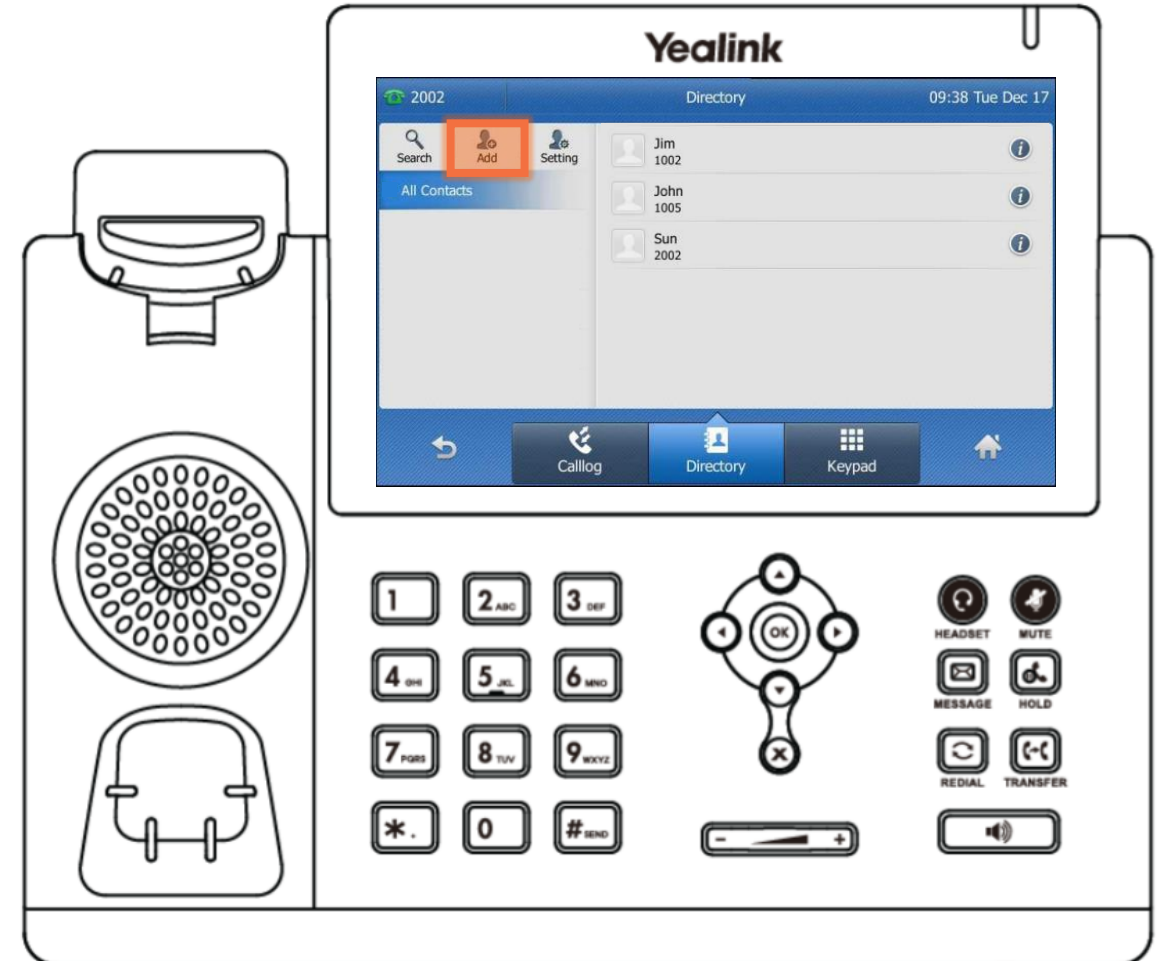

Adding a Contact

After the contact information is entered using the dial pad:

- Tap **Save** 



The newly added contact will be saved in the local directory for the phone.

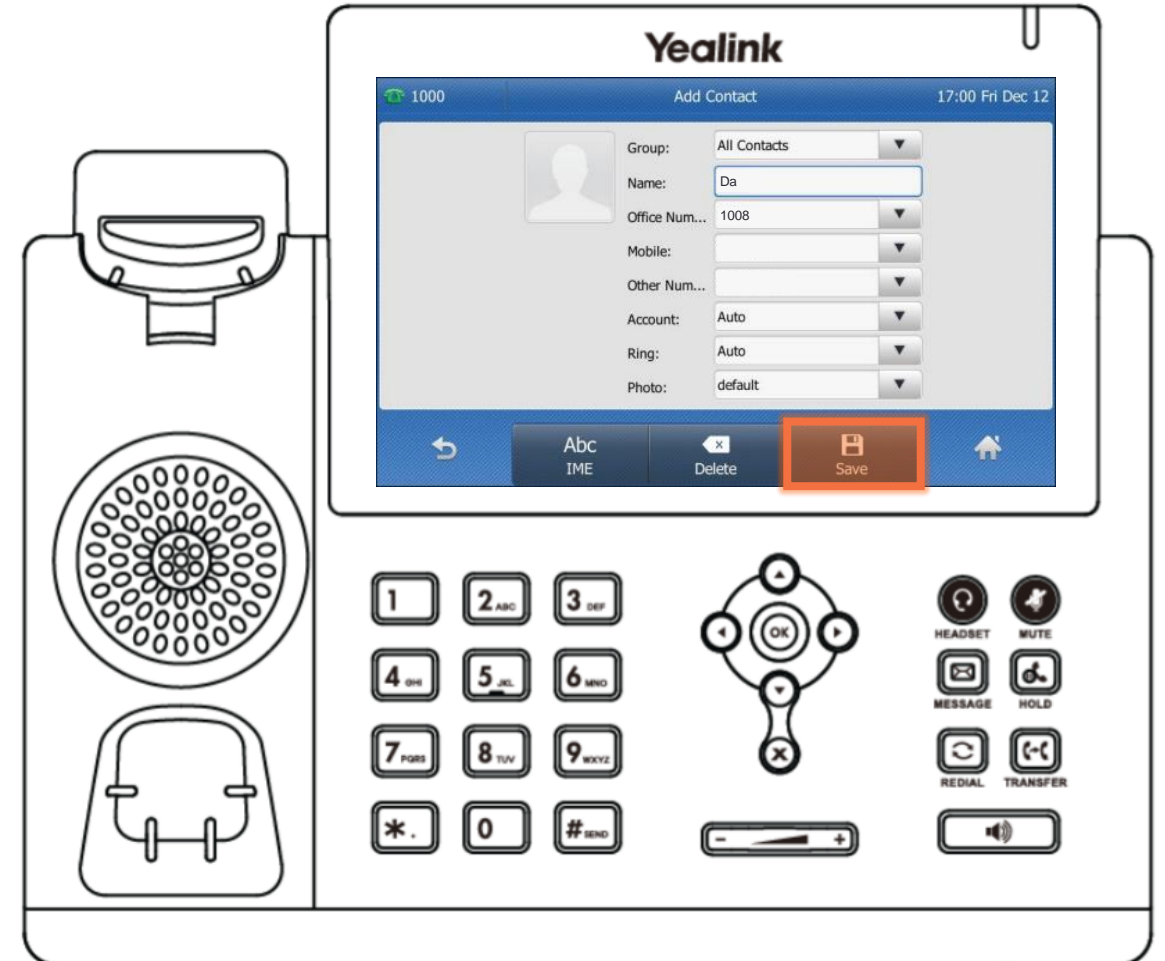

Editing a Contact

To edit contact information:

- Locate the contact in a directory
- Tap the  icon

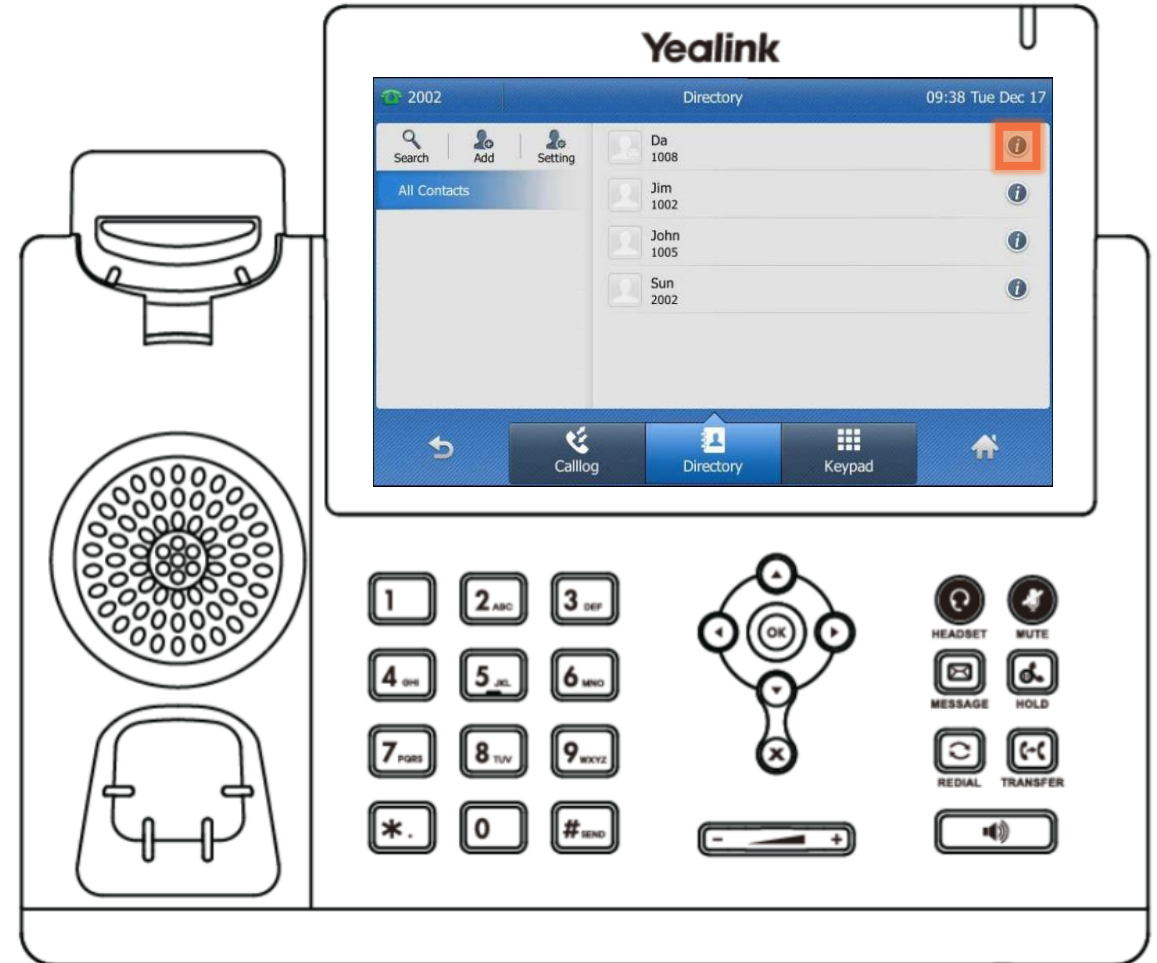

Editing a Contact

Tap the fields to select the contact information to edit:

- Use the dial pad to edit the information
 - Using “0” permits the entering of a space between the contact’s first and last name
- Tap **Save**

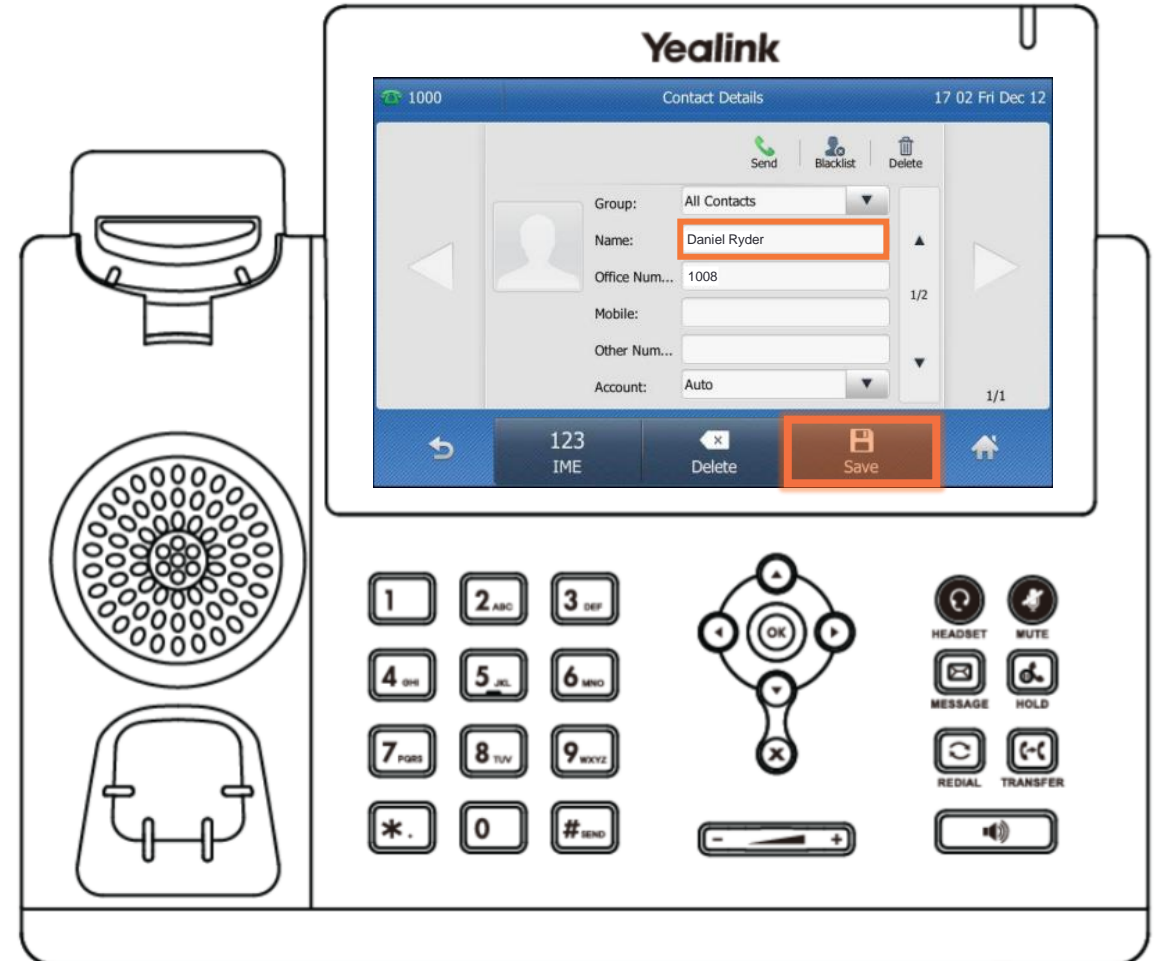

Deleting a Contact

To delete a contact from within the directory:

- Locate the contact
- Tap the  icon

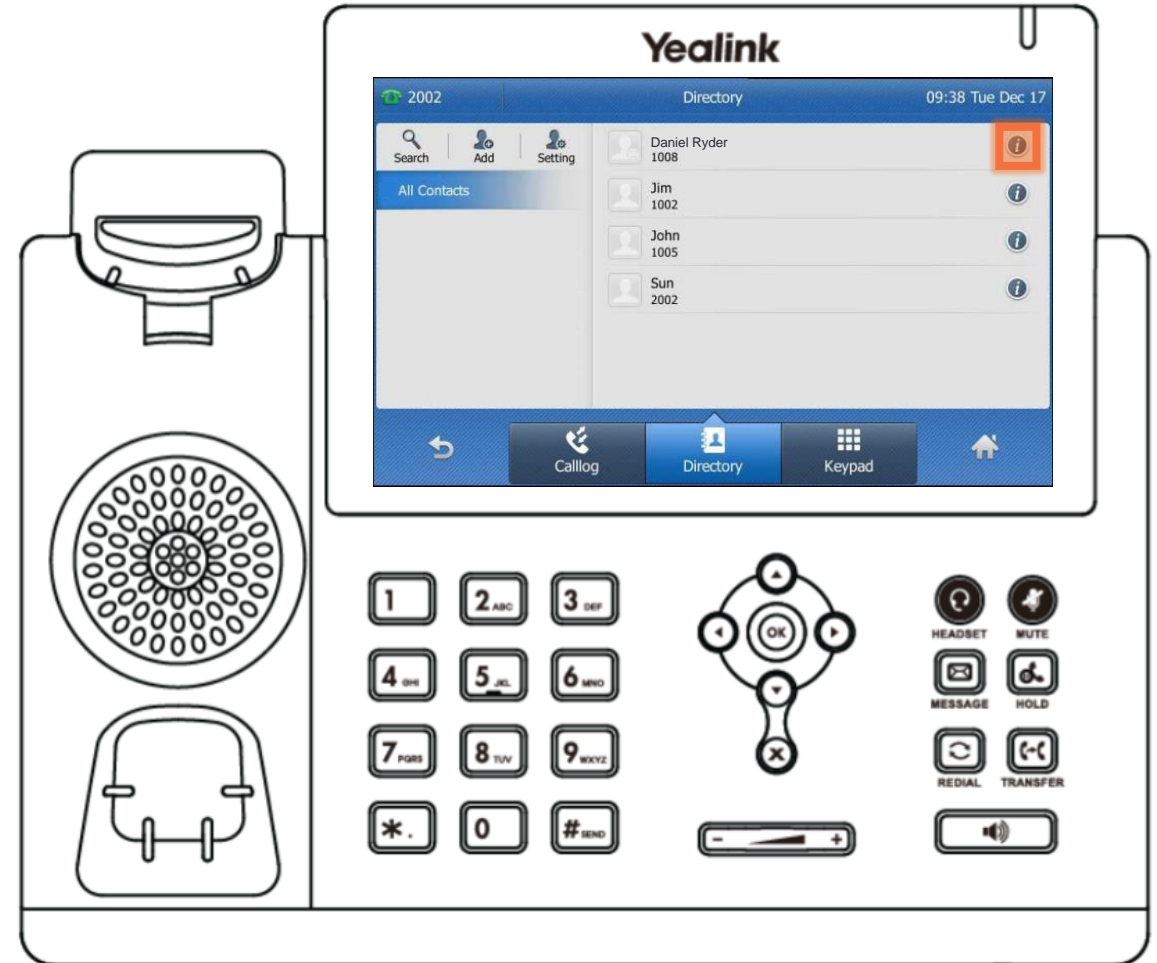

Deleting a Contact

- Tap **Delete** 

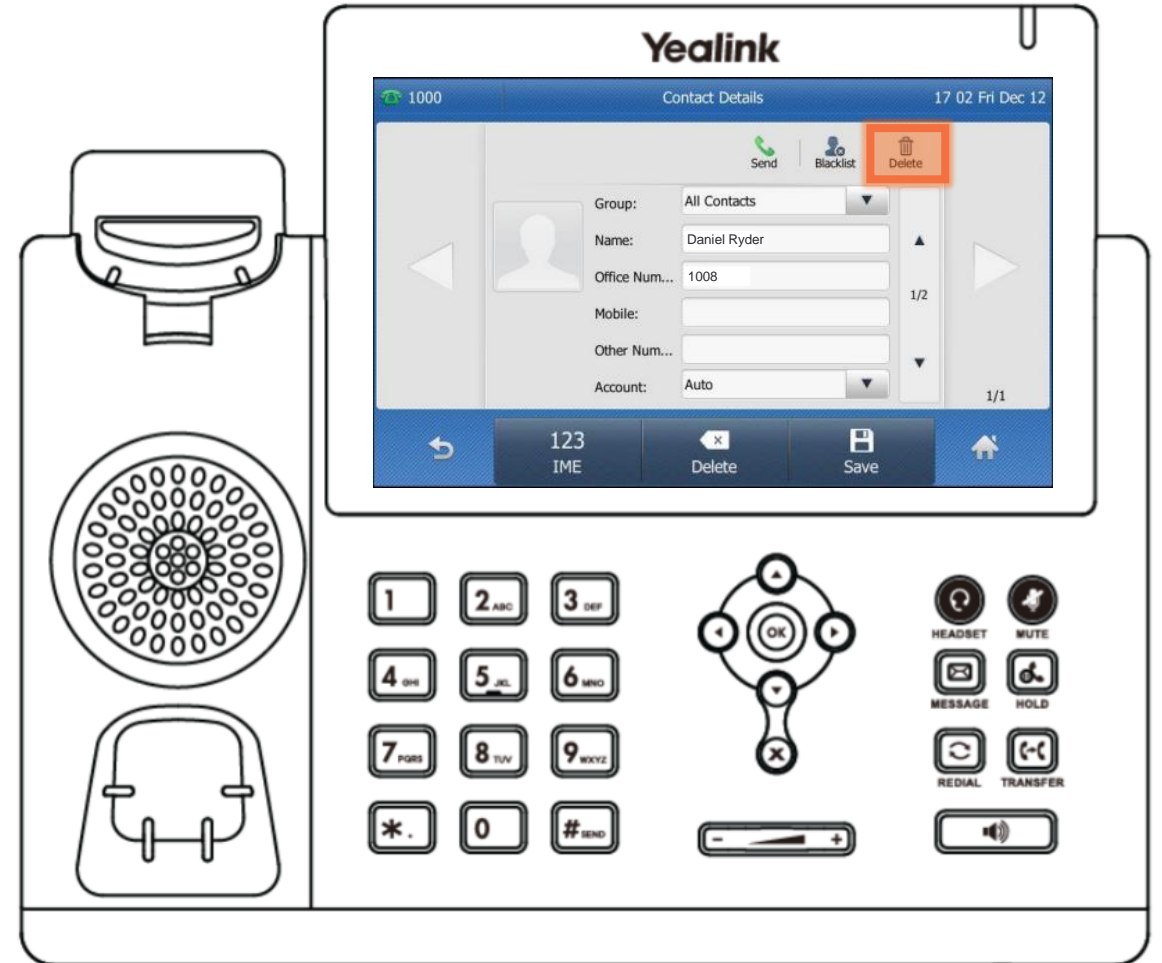

Deleting a Contact

- Tap **OK** to confirm



Deleting a contact removes them from the selected directory.

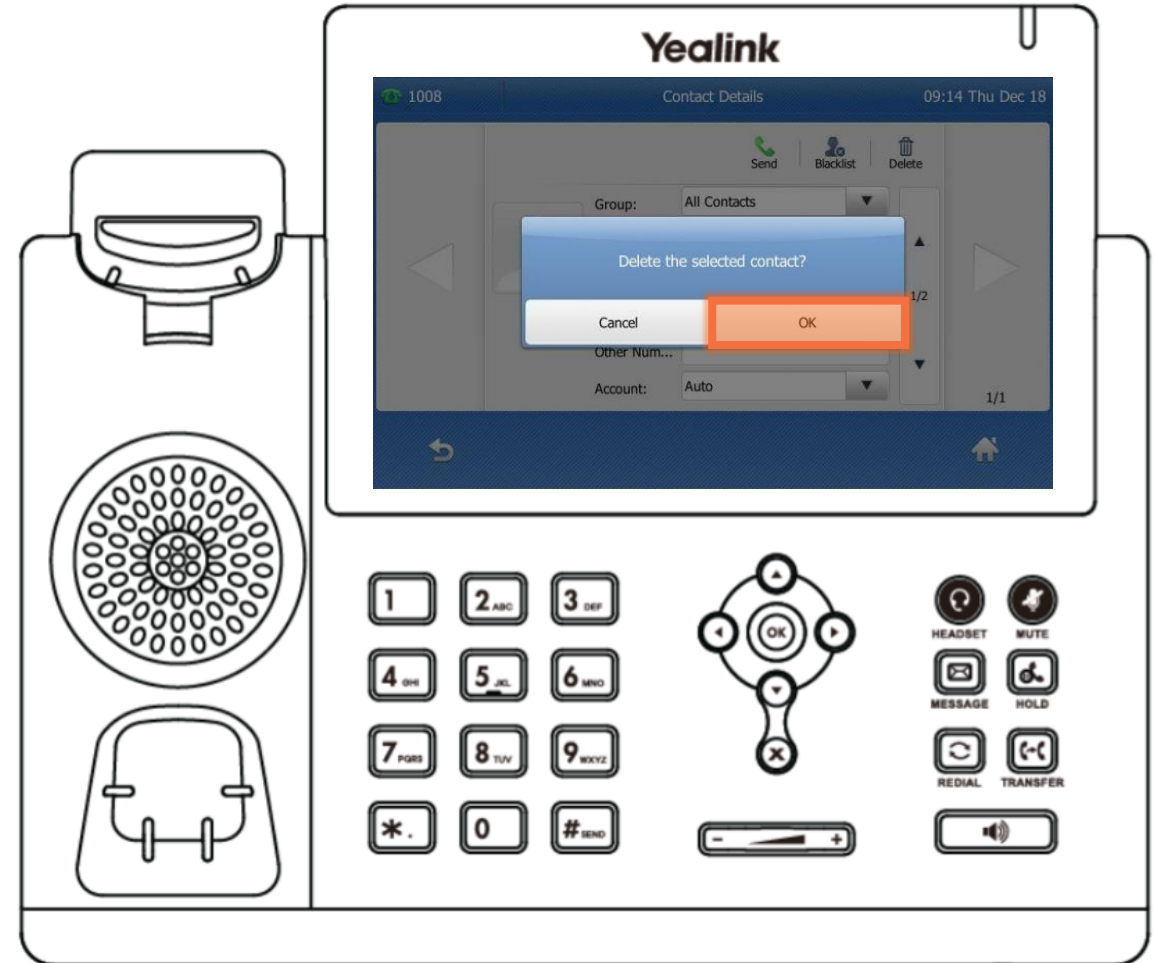

Adding a Speed Dial

Along with Oliver, Martina is a contact that is often called. It would be beneficial to add her contact to speed dial. This way, Martina can be called by tapping the associated line key.

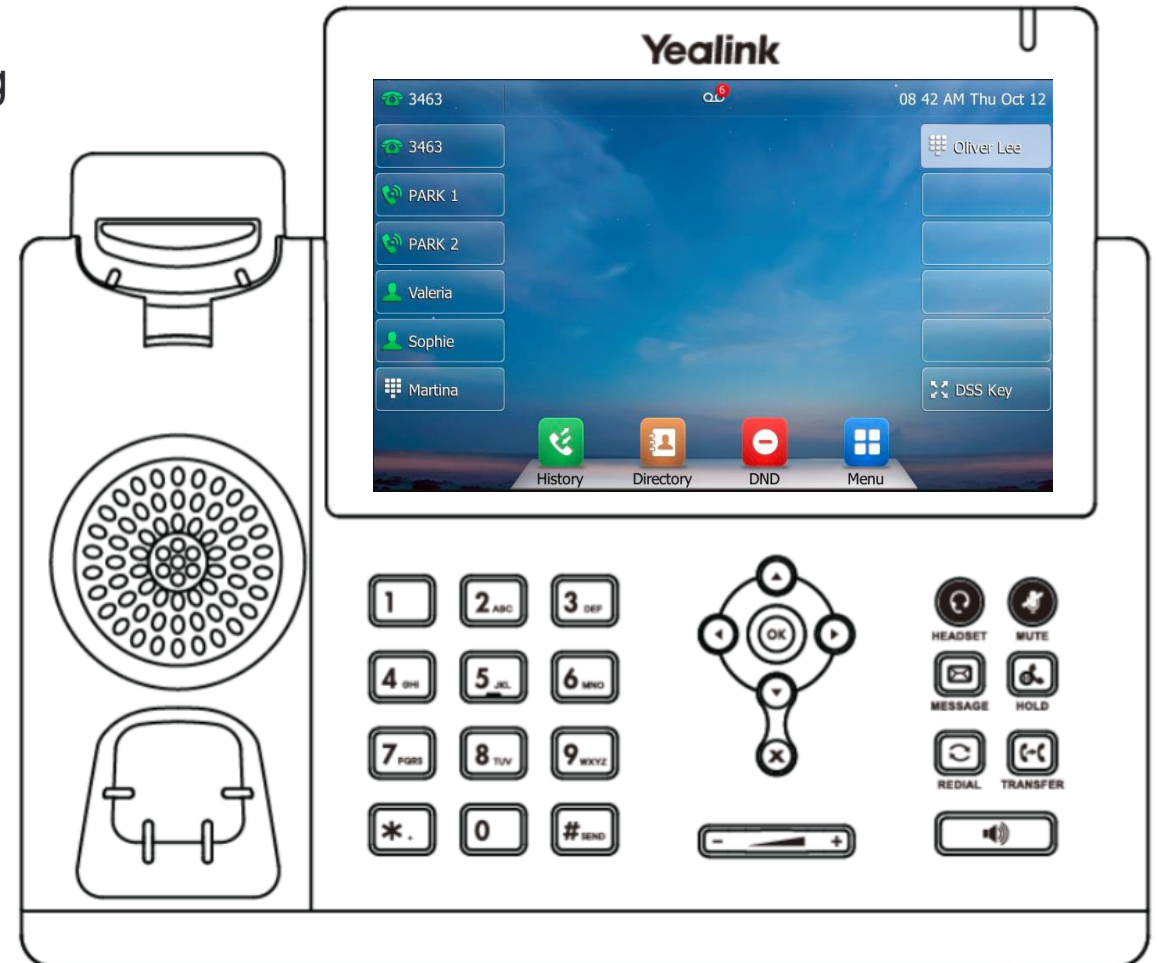

To add a contact to speed dial:

- Tap and hold the desired line key
- Tap the **Type** and select **Speed Dial**
- Tap the **Label** field and enter the contact's name by using the dial pad
- Tap **Value** to enter the contact extension
- Tap **Save** to save the entry



Buddy Lists

A Buddy List is a list of speed dial users whose status can be monitored from the phone.

-  A green indicates the contact is currently available
-  A red icon indicates the contact is currently on a call

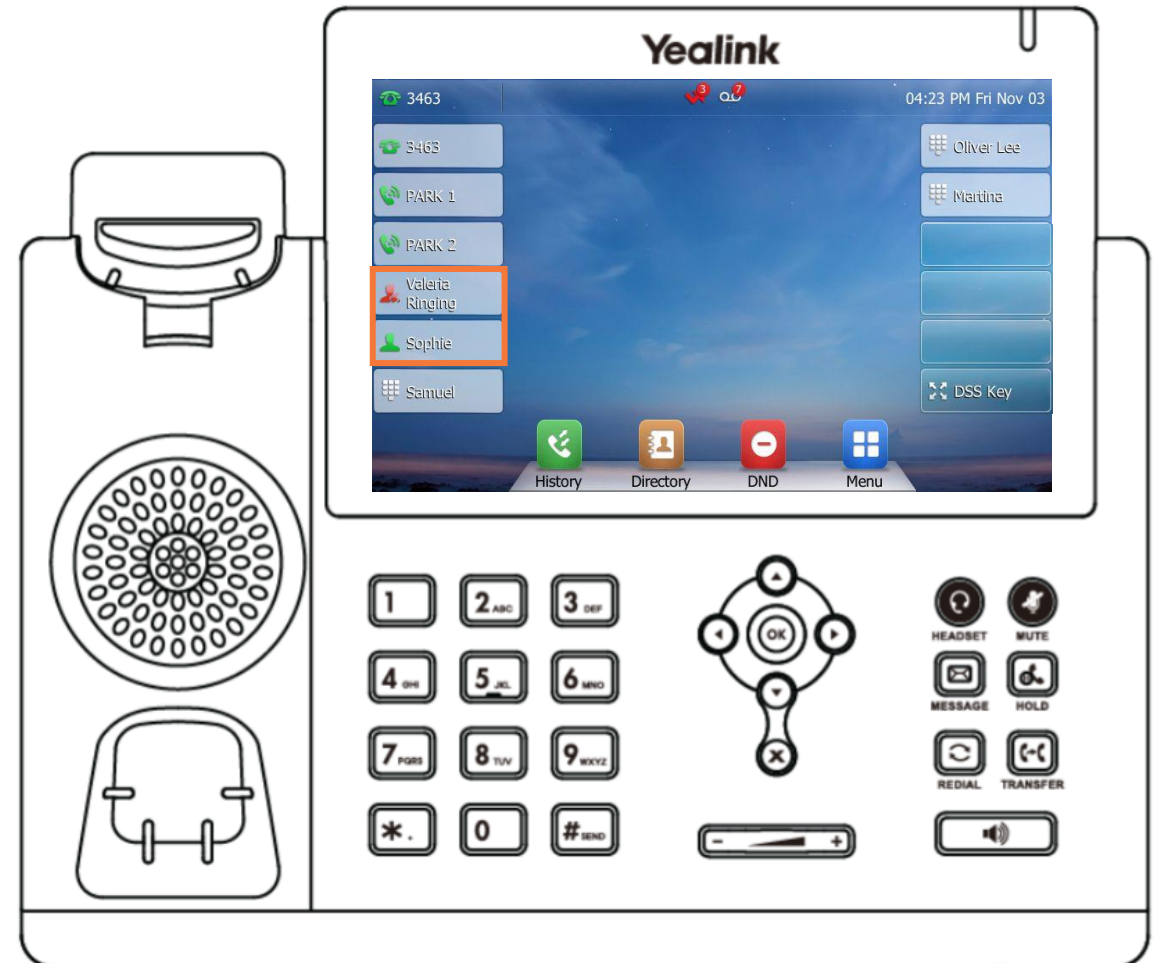

Knowledge Check

You will now be given an ungraded knowledge check to test your understanding of this module.

When you are ready, click Next to begin.

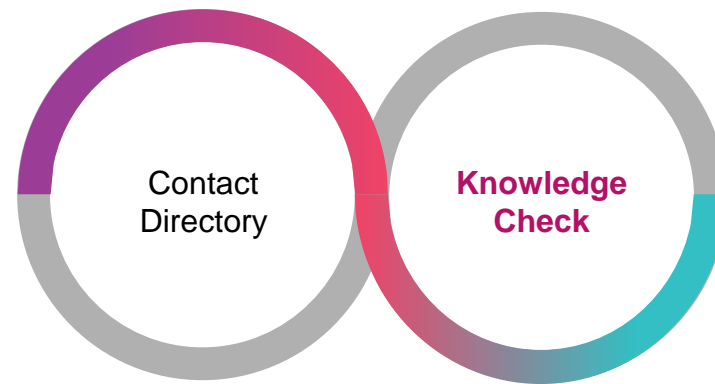

Knowledge Check 1 of 4

Click on-screen the correct key that will allow you to access the Contact Directory.

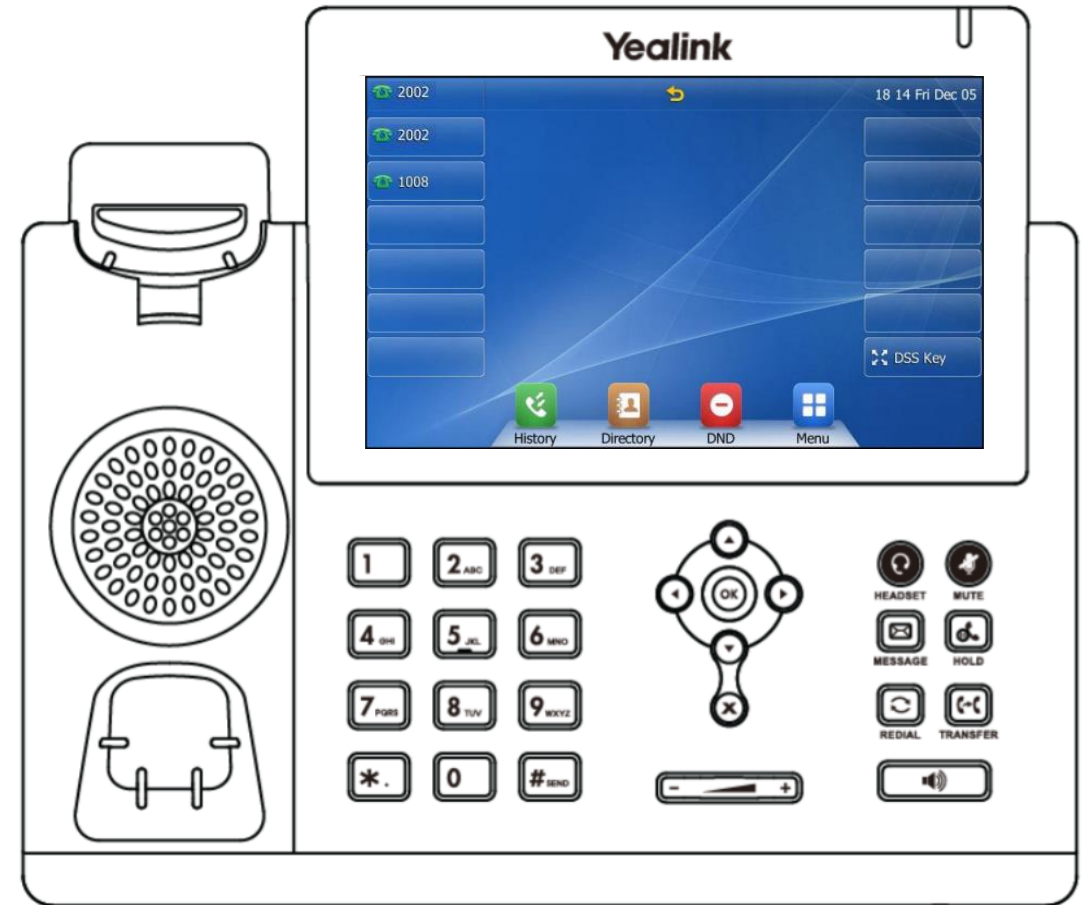

Knowledge Check 1 of 4

That is correct!

To access the contact directory, tap the **Directory** shortcut key.

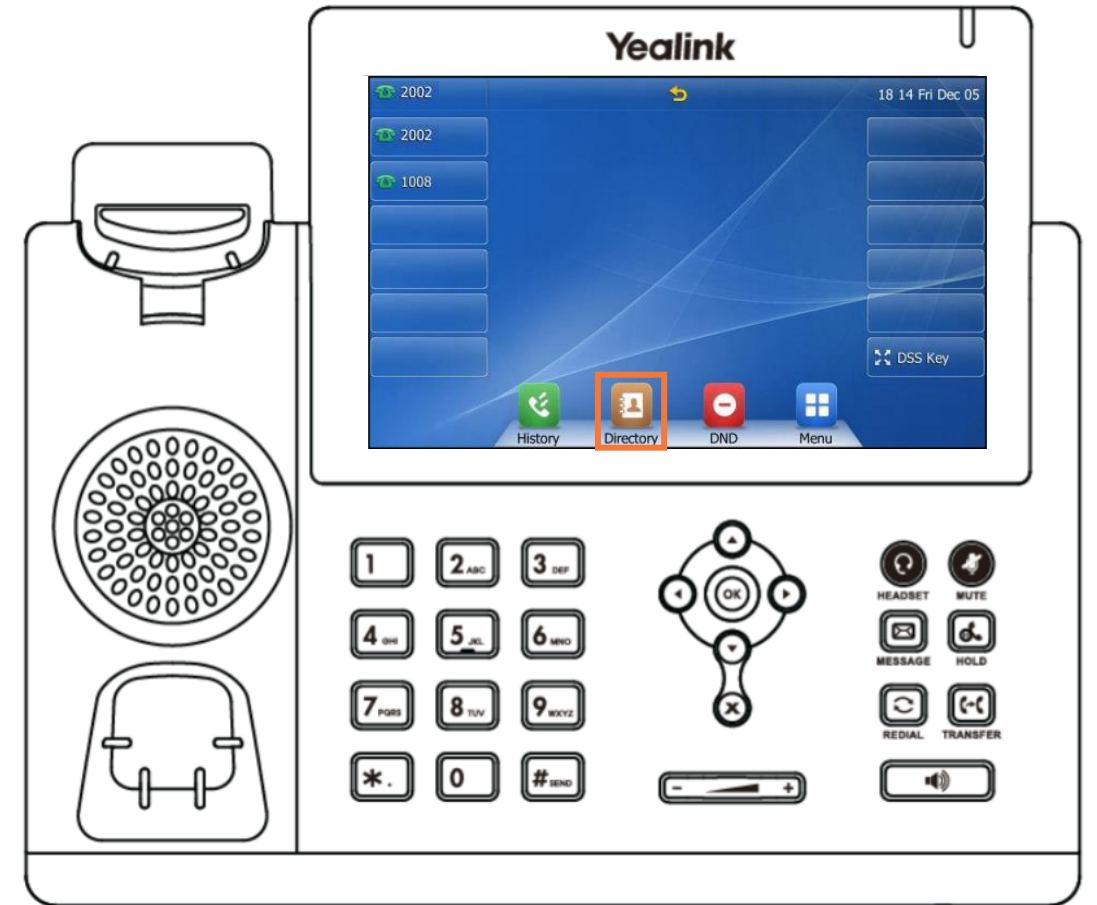

Knowledge Check 1 of 4

Sorry, that is incorrect.

To access the contact directory, tap the **Directory** shortcut key.

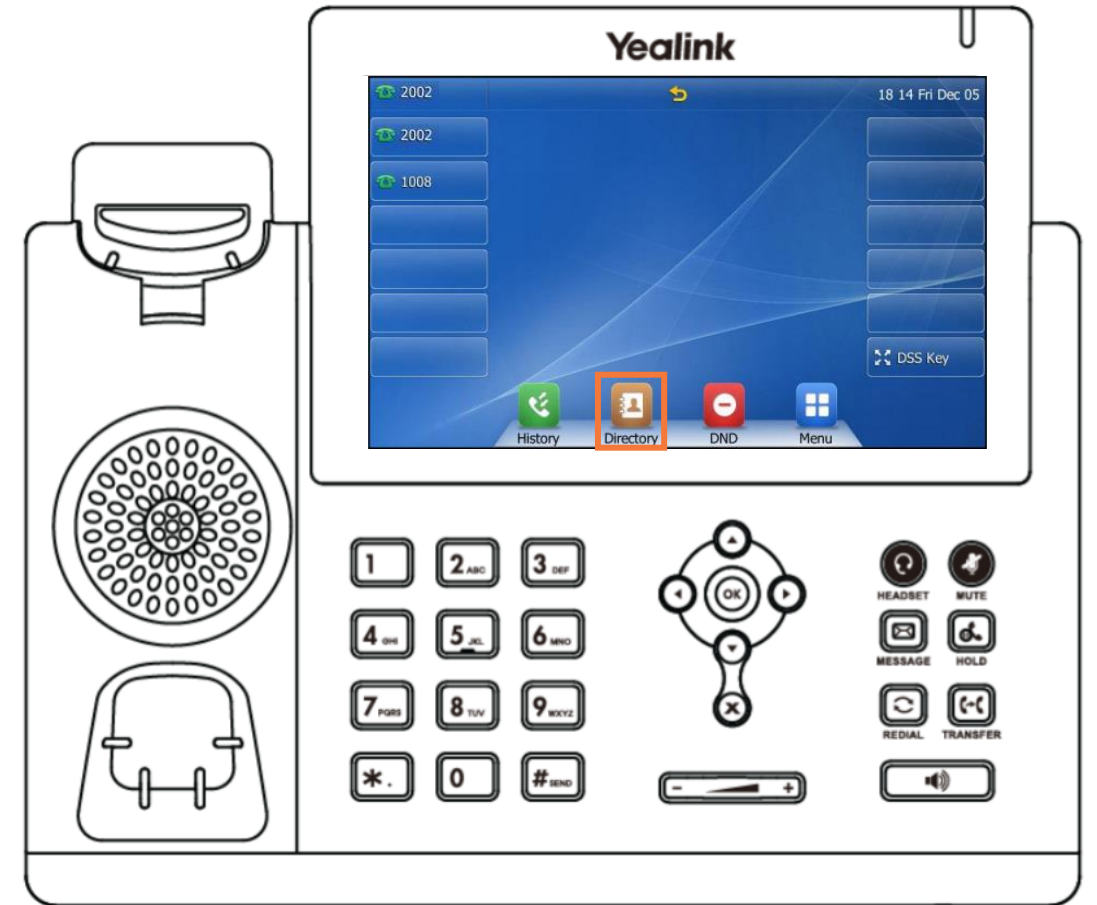

Knowledge Check 2 of 4

True or False. A red icon in the buddy list indicates that contact is on a phone call.

True

False



Knowledge Check 2 of 4

That is correct!

A red icon indicates that the contact is currently on a call. While a green icon indicates that the contact is currently available.

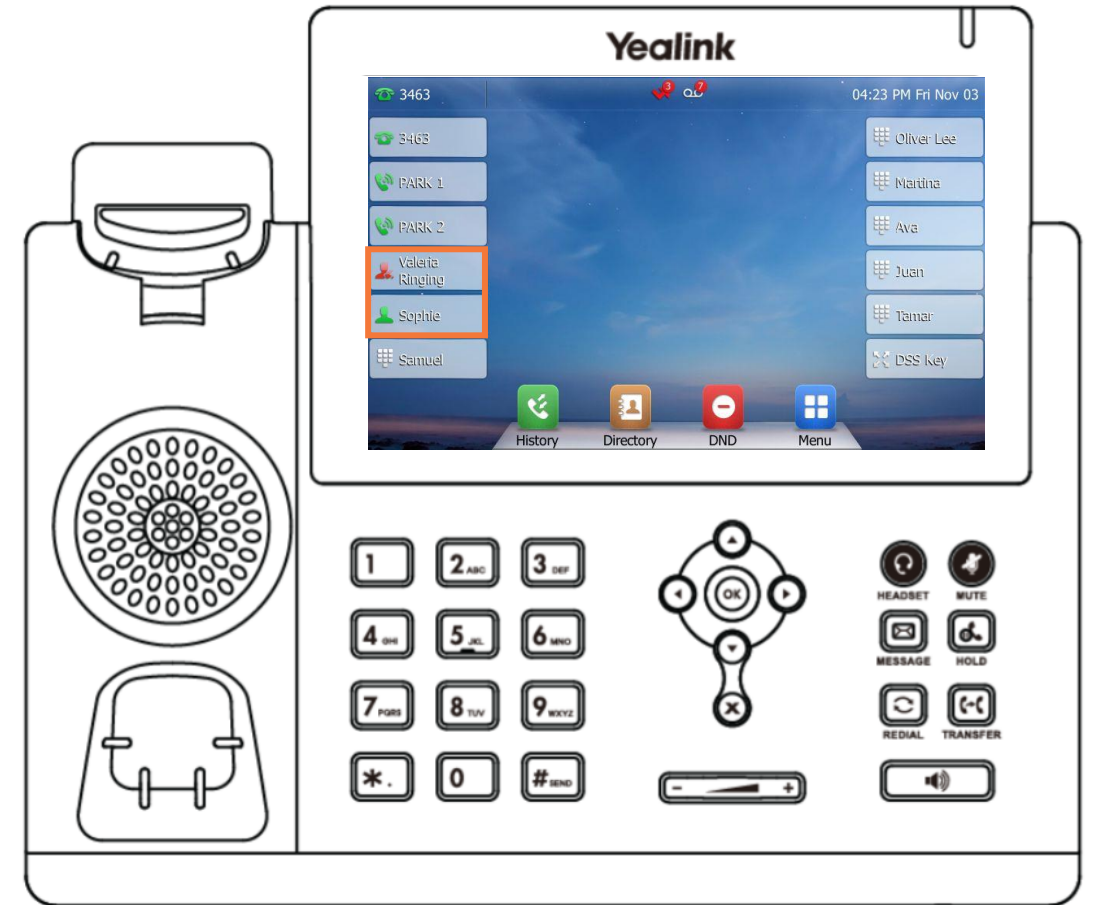

Knowledge Check 2 of 4

Sorry, that is incorrect.

A red icon indicates that the contact is currently on a call. While a green icon indicates that the contact is currently available.



Knowledge Check 3 of 4

True or False. A newly added contact will be saved in the local directory for the phone.

True

False

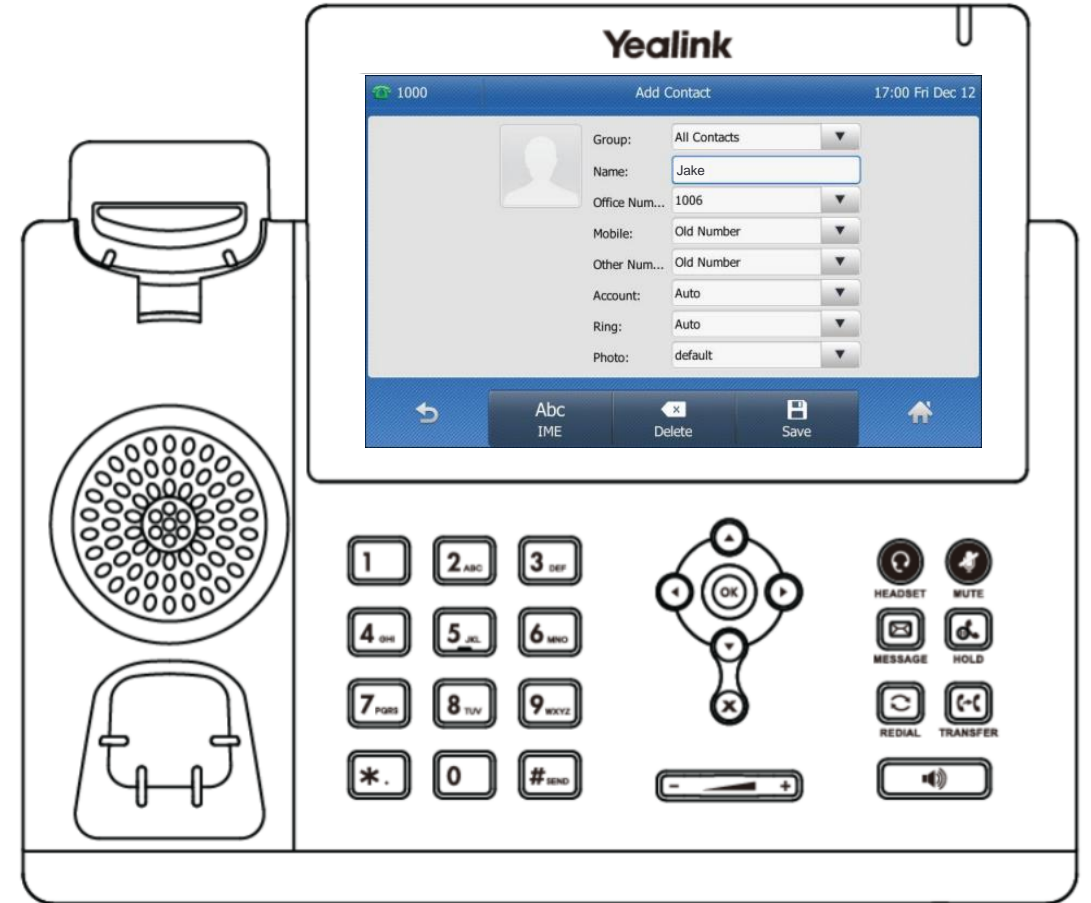

Knowledge Check 3 of 4

That is correct!

The newly added contact will be saved in the local directory for the phone.

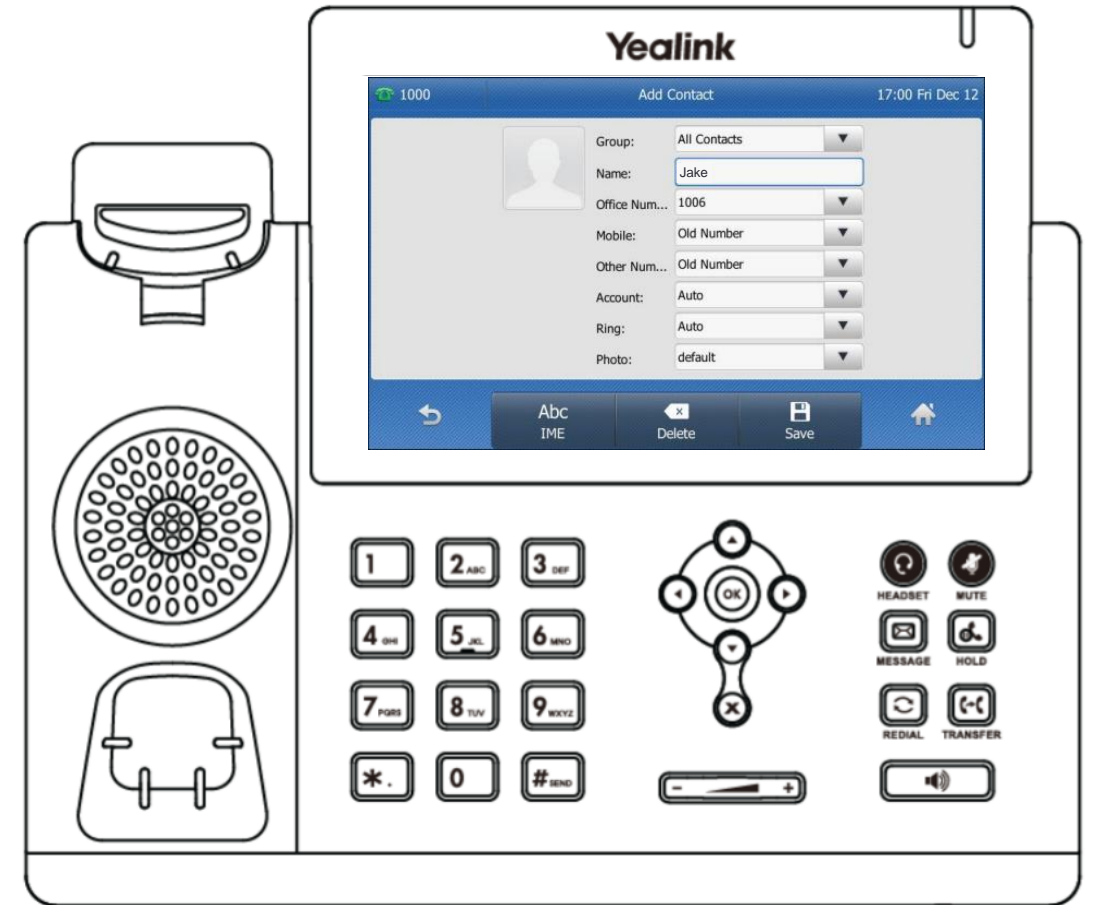

Knowledge Check 3 of 4

Sorry, that is incorrect.

The newly added contact will be saved in the local directory for the phone.

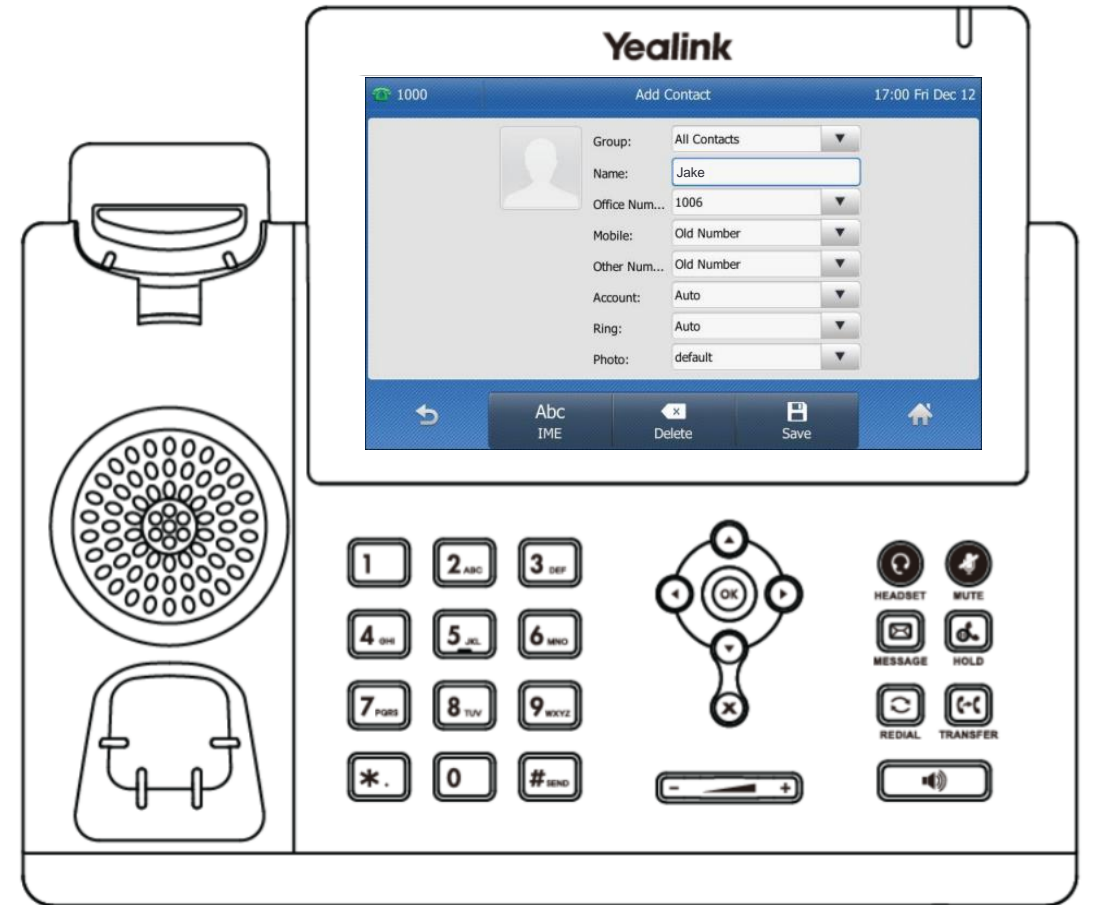

Knowledge Check 4 of 4

Click on-screen the correct key that will allow you to edit a contact's information.

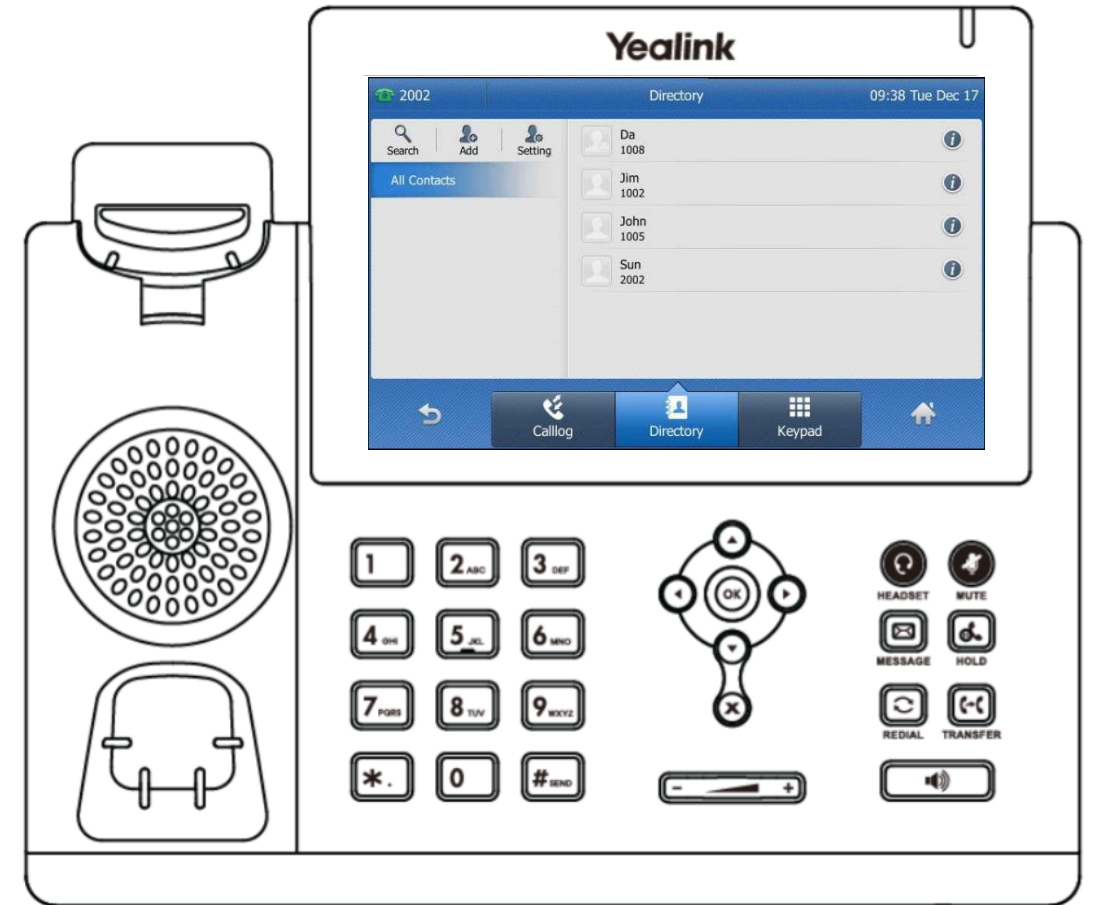

Knowledge Check 4 of 4

That is correct!

To edit a contact, press the  icon associated with the contact.

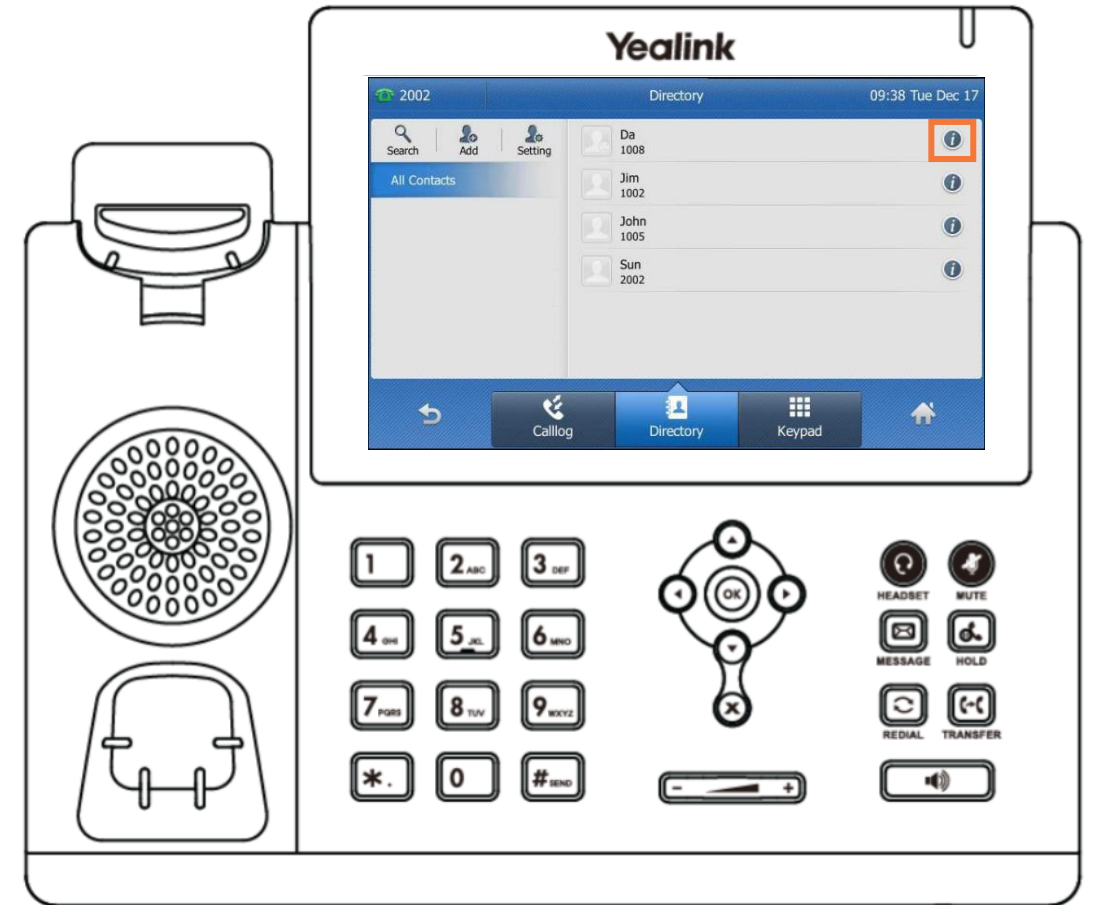

Knowledge Check 4 of 4

Sorry, that is incorrect.

To edit a contact, press the  icon associated with the contact.

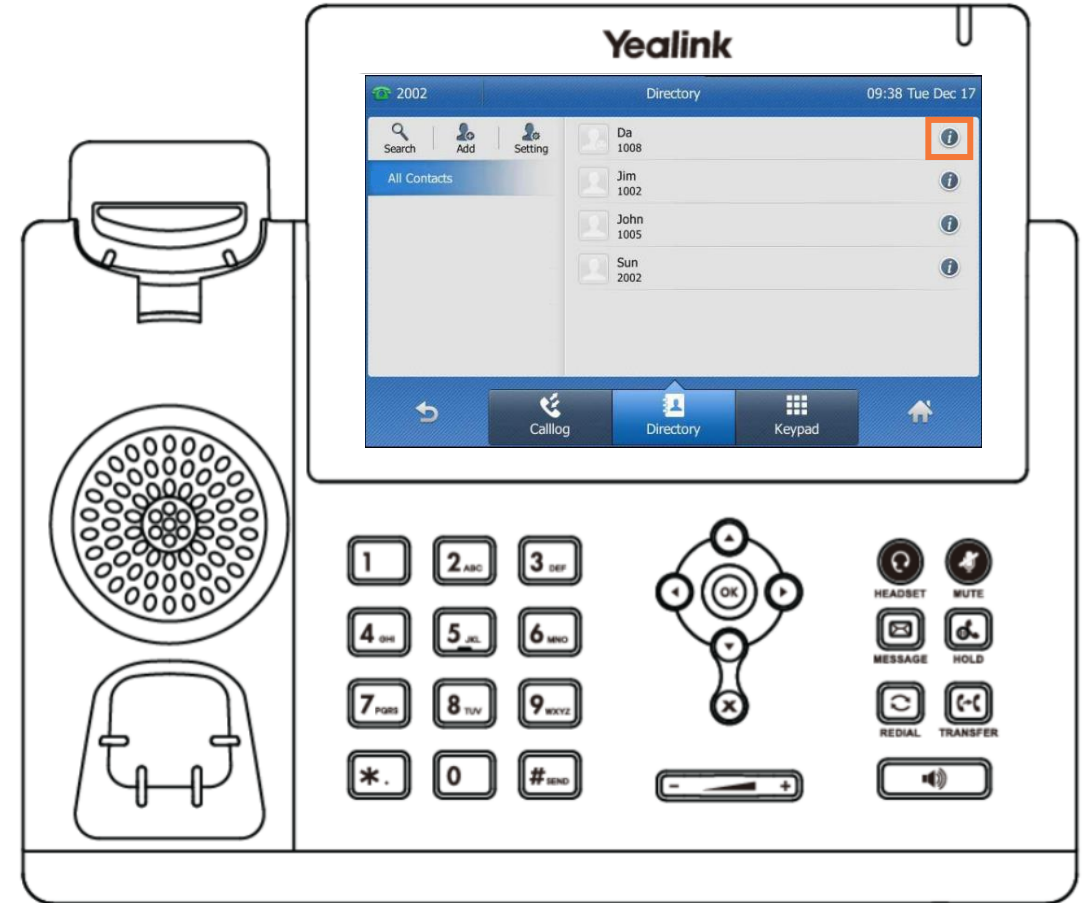

Contact Directory Complete

You have now completed the contact directory module for your Yealink device.

Click a section title to review that section or click Restart to review this module.

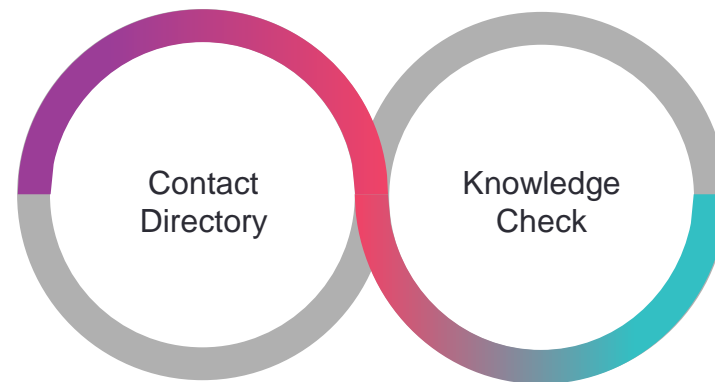

Restart